

INDEX TABLE

TR
1000

MESA DE GIRO

CAD File: TR 1000
2D - 3D

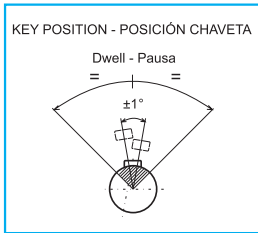
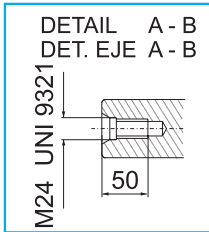
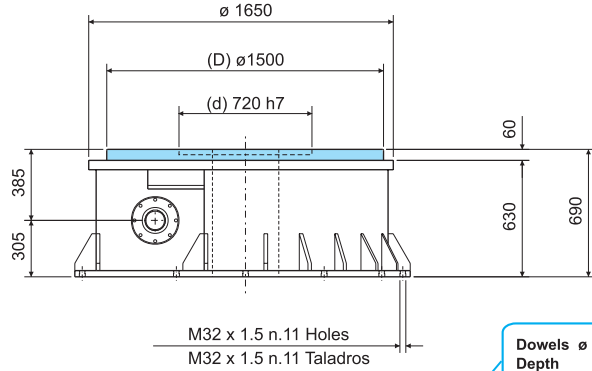

ENG WEIGHT	
4750 Kg	10472 Lbs
CAST IRON ALLOY HOUSING	
CONVENTIONAL REPRESENTATION	
REPRESENTACION CONVENCIONAL	
CAJA EN FUNDICION	
4750 Kg	10472 Lbs
ESP PESO	

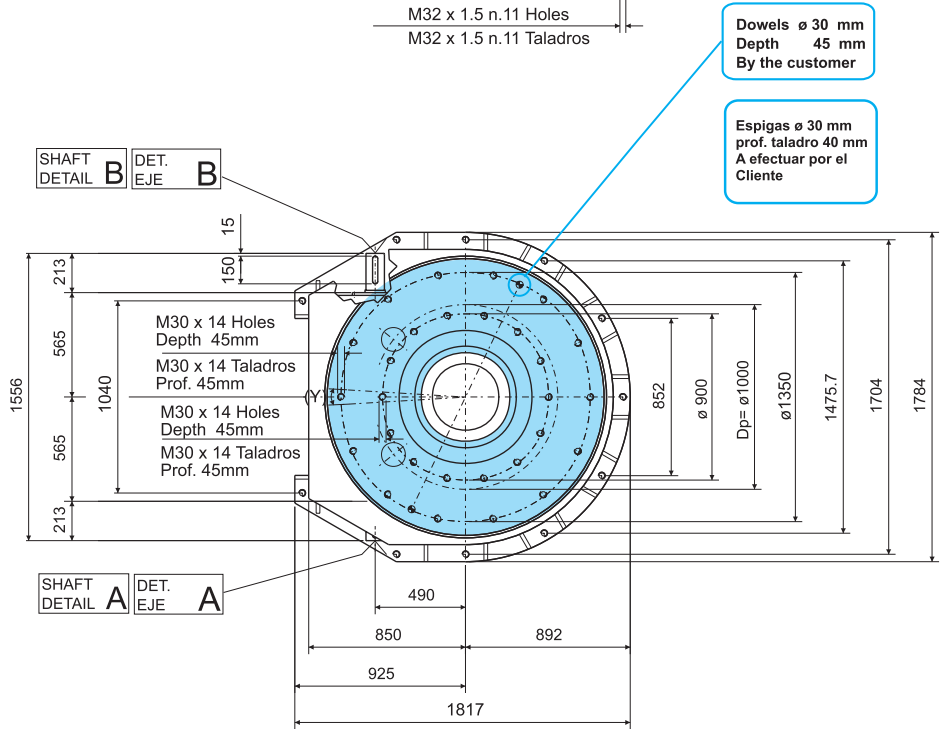

Rotating element - Elemento de Giro

 SHAFT A - B	Reference	Concentricity	Planarity	Repeatability referred to pitch radius Rp Higher precision levels on request			(Y) Position of the threaded holes	General manufacturing tolerance in compliance with UNI - ISO 2768-1 EN 22768-1
	d	± 0.05 mm		Standard	2 cycles cam	3 cycle cam		
STD diameter	$\frac{h8}{k8}$ 100 106 28 16	D	± 0.05mm			*	1.1 mm 6'	
MAX diameter	110 116 28 16	Dp			± 0.02 mm ± 8"	± 0.03 mm ± 12"		
Diámetro MAX	110 116 28 16	Dp			± 0.02 mm ± 8"	± 0.03 mm ± 12"	± 0.04mm ± 16"	1.1 mm 6'
Diámetro SDT	$\frac{h8}{k8}$ 100 106 28 16	D	± 0.04mm			*	(Y) Posición taladros	
 EJE A - B	Referencia	Concentricidad	Planaridad	Estándar	2 Principios	3 Principios		
				Ripetibilità con referencia al radio primitivo RP	Precisiones superiores a pedido			