

TOOL CHANGER CU 125

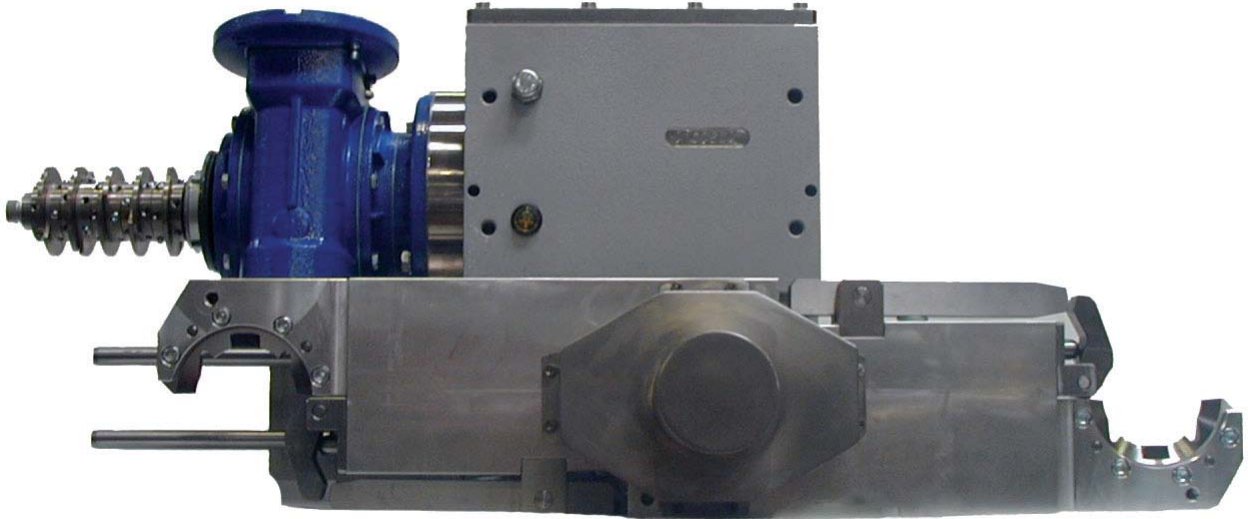

CU 125
meeting a new challenge!

July 08

C006eng/0



CDS div. Bettinelli f.lli S.p.A.
Via Leonardo da Vinci n.56
I-26010 Bagnolo Cremasco (CR)
www.cdsindexers.eu
cds@bettinelli.it

C.D.S. GmbH
Ulrichstr. 9
D-86641 Rain - Sallach
www.cdsindexers.de
info@cdsindexers.de



CDS CORP
27, Wilson Drive Unit C
07871 Sparta -NJ- USA
www.cdsindexers.com
info@cdsindexers.com

TOOL CHANGER CU 125

The CU 125 system is a mechanical cam-driven tool changer combining an intermittent series of linear and rotary movements which perform the tool change:

- cone gripping
- extraction (from the tool pockets and spindle)
- changeover
- insertion (in the tool pockets and spindle)
- release

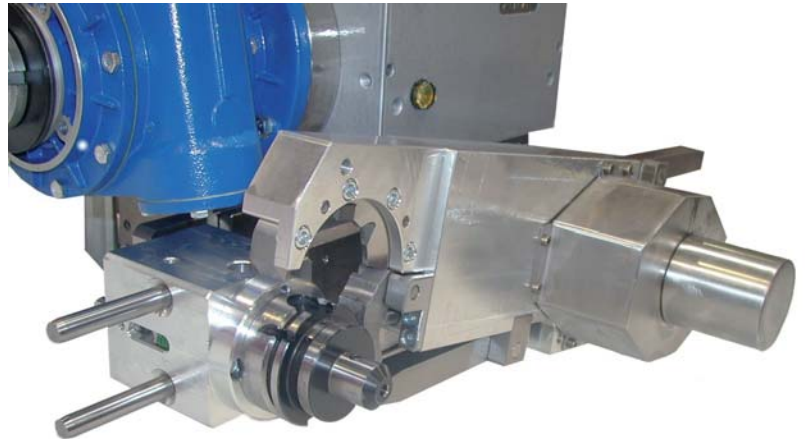

CHARACTERISTICS

A mechanical tool safety lock on the gripper holder arm guarantees safe tool transfer during changeover.

- Type of tool handled HSK063/HSK050
- Tool change arm with centre distance 515 mm.
- Synchroniser limiter coupler on reduction gear shaft
- Version with unit driven by two-speed brake induction motor.

Cycle times:

B) tool up to 5 Kg. (tot. 10 Kg.) = cycle time 1.5 sec.

C) tool up to 10 Kg. (tot. 20 Kg.) = cycle time 2 sec.

- Version with unit driven by Servomotor. Cycle times:

A) tool up to 3 Kg. (tot. 6 Kg.) = cycle time 1.2 sec.

B) tool up to 5 Kg. (tot. 10 Kg.) = cycle time 1.5 sec.

C) tool 10 Kg. (tot. 20 Kg.) = cycle time 2 sec.

NB: The unit is able to handle up to 2 tools of 20 Kg. (tot. 40 Kg.), operating with a cycle time of 2.5 sec.

- Weight = 140 Kg.

A second synchroniser coupling can be fitted directly on the tool changer output shaft with no change to the overall dimensions.

Can be installed horizontal or vertical.

TOOL CHANGER CU 125

REST POSITION

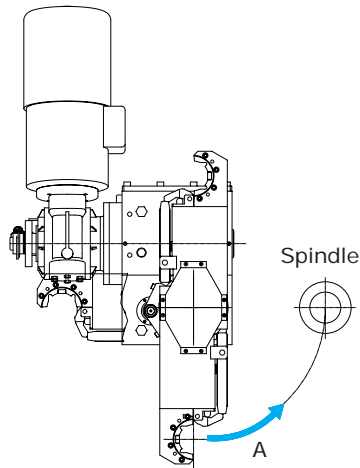

TOOL GRIPPING POSITION

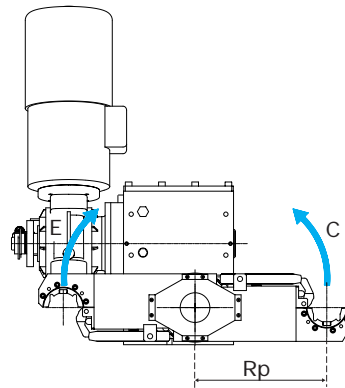

TOOL EXTRACTION/CHANGEOVER

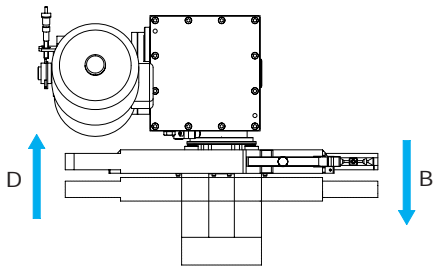

N.B.: The time stated in the table refers to a complete changeover cycle, i.e. 360° of drive input shaft rotation

	Rp=257,5
3	1,2
5	1,5
10	2
TOOL WEIGHT. "Kg"	TIME MAX. "Sec"

GRIPPER ARM EXTRACTION DIAGRAM

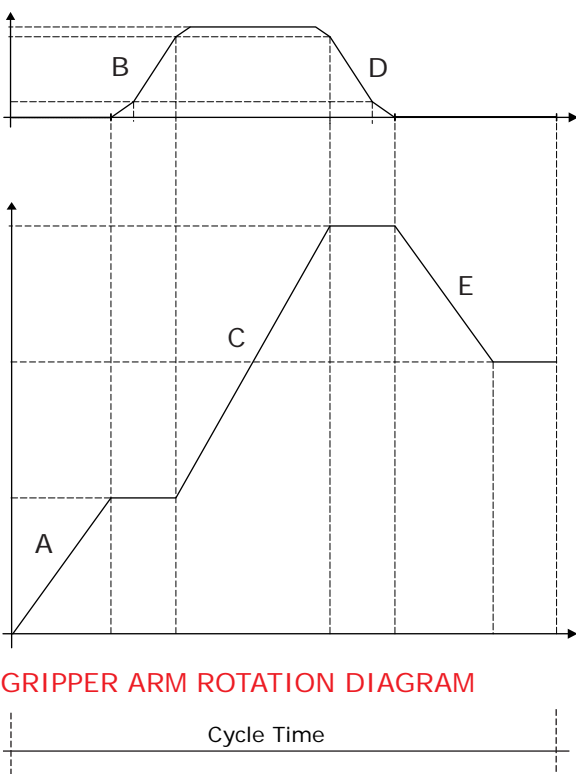

CYCLE DIAGRAM PHASE DESCRIPTIONS

PHASE – A:
90° rotation to grip spindle/magazine tool

PHASE – B:
Tool extraction

PHASE – C:
Magazine/spindle tool changeover

PHASE – D:
Tool insertion

PHASE – E:
Gripper arm return to rest position

TOOL CHANGER CU 125

CU125 + GRIPPER ARM, RIGHT-HAND VERSION

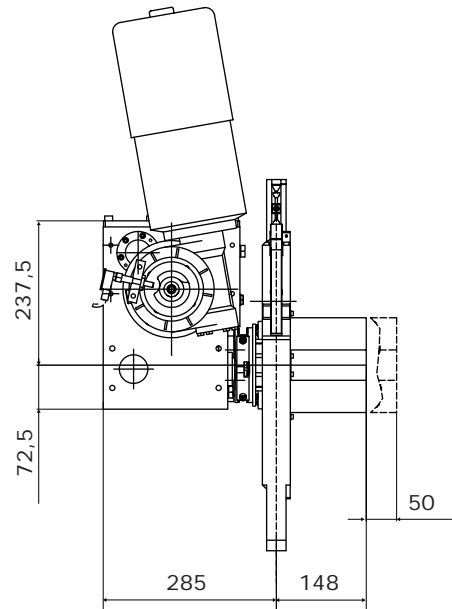
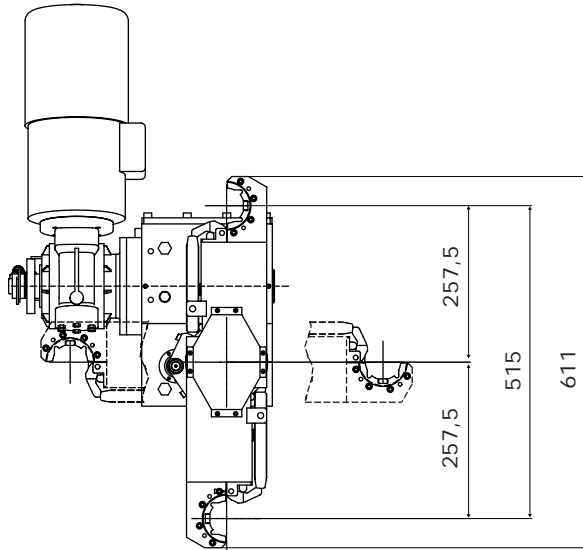
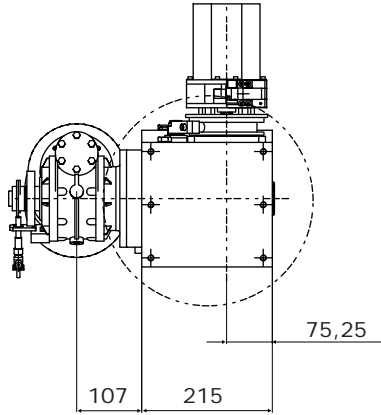

CU125 + GRIPPER ARM, LEFT-HAND VERSION

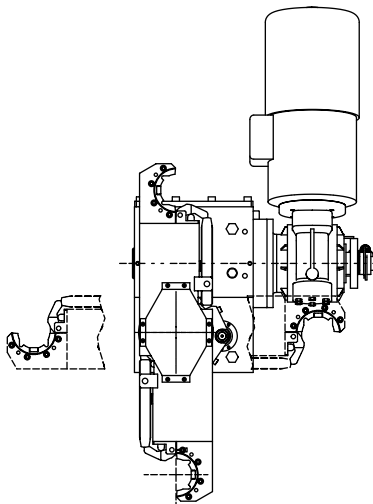

HOLES IN BASE FOR UNIT MOUNTING

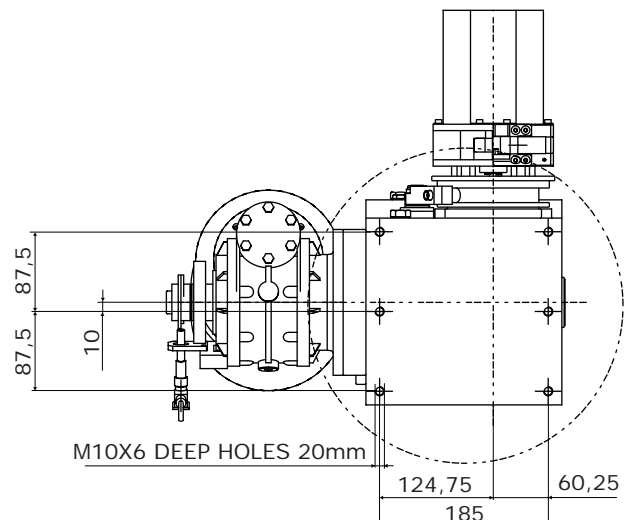

Division



HEAD OFFICE EU
C.D.S. div. di Bettinelli F.lli S.p.A.

Via Leonardo da Vinci n.56
I-26010 Bagnolo Cremasco (CR)

Tel. +39 0373 237 311
Fax +39 0373 237 538

Web: www.cdsindexers.eu
E-mail: cds@bettinelli.it



HEAD OFFICE DE
C.D.S. GmbH

Ulrichstr. 9
D-86641 Rain - Sallach

Tel. +49 90 90 921 112
Fax +49 90 90 921 112

Web: www.cdsindexers.de
E-mail: manfred.fischer@cdsindexers.de



HEAD OFFICE USA
C.D.S. CORP.

27, Wilson Drive Unit C
07871 Sparta -NJ- USA

Phone +1 973 300 0090
Fax +1 973 300 0061

Web: www.cdsindexers.com
E-mail: info@cdsindexers.com

